

1

2

3

4

TECHNICAL CHARACTERISTICS :

Screw locks: brass, tin plated .

Locking washer: steel, tin plated .

Nuts : steel, tin plated .

Packaging : per 100 pieces .

Corrosion resistance : 50 hour exposure to salt spray .

For the plating codification see GS-15-005

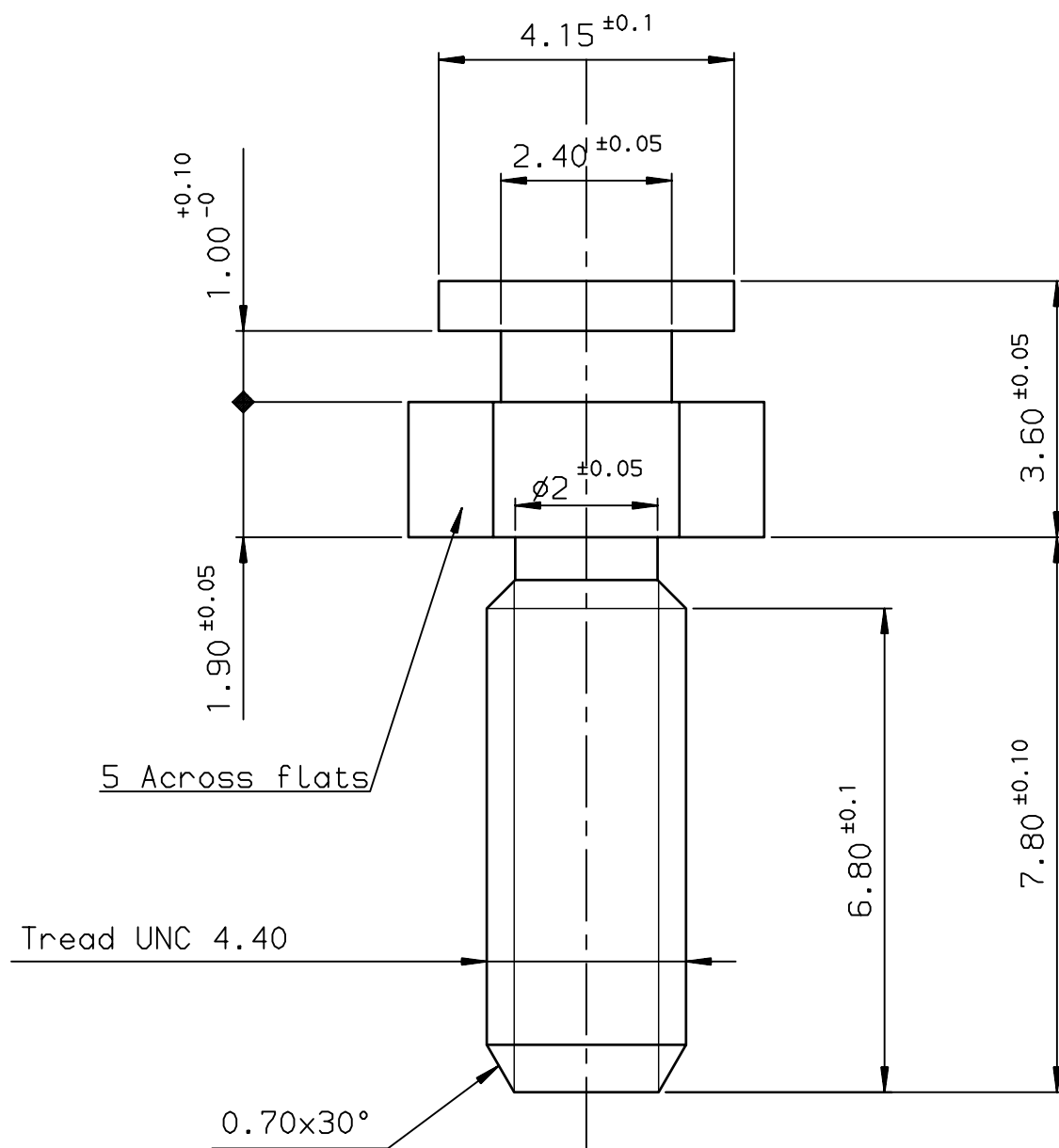

NOTE:RoHS INFORMATIONS

- The "LF" products meet European union Directives and other country regulations as described in GS-22-008.
- Plating Sn (pure bright) over copper

TIN LEAD PART NUMBER 86308278T
 LEAD FREE PART NUMBER 86308278TLF

European Views

www.fciconnect.com		surface ISO 1302	tolerance std ISO 406 ISO 1101	projection mm
TOLERANCES UNLESS OTHERWISE SPECIFIED				
Dr	MASSON	2000/08/08	ANGULAR	size A3
Eng	MASSON	2000/08/08	LINEAR	Scale 10
Chr	M PESSON	2000/08/08	0.XX' $\pm 2'$	ECN LS06-0208
Appr	LEGARE	2000/08/08	Product family	Spec ref -
FCi		title MOUNTING POSTS		Rev. C
catalog no		-		dwg no C01-8655-1543
		CUSTOMER		sheet 1 of 1

rev	ecn no	dr	date
B	LS05-0026	LMA	2005/02/09
C	LS06-0208	LGO	2006/12/12
-	-	-	-
-	-	-	-
-	-	-	-
-	-	-	-

Copyright FCI. FCI